

### Contents :



4 – Casters



4 – Decorative Side Handle (with Hardware, 20 Screws)



8 – Black Metal Corner Protectors (with Hardware, 32 Screws)



1 – Hardware Bag, 16 Long Screws (For Side Panels & Top/Bottom Shelf)



2 – Top / Bottom Shelf (C)



Insert Liner (E)



Center Divider (D)



2 – Side Panel/ Metal Legs (A)



2 – Side Panel No Legs (B)

### STEP 1

On flat surface, Lay 1 Side Panel with Legs (A) on flat surface so the metal legs are facing up. Attach 1 Side Panel No Legs (B) using 2 Long Screws with a screw driver.



### STEP 2

Attach 1 Side Panel No Legs (B) using 2 Long Screws with a screw driver to the opposite side of the Side Panel with Legs (A).



### STEP 3

Slide 1 Top/Bottom Shelf (C) from the open end into the cleats of the side panels (A) & (B).



# VINTAGE ORCHARD BIN

## assembly instructions

**STEP 4** Install 1 Side Panel with Legs (A) to the open side of the assembly from previous steps. Line up the holes in the metal legs to the holes in the 2 Side Panels no legs (B) and use 4 long Screws



**STEP 5** Install 4 Casters to the threaded inserts in the metal legs.



**STEP 6** With the help of a second person, flip the bin upward so that it is resting on the casters. Using a screw driver, check that all 16 screws (4 per side) are tight.



**STEP 7** Install 4 Casters to the threaded inserts in the metal legs.



**STEP 8** Insert Center Divider (D) into the cleats and slide it all the way into the bin.



**STEP 9** Drop the Top Shelf (C) into position and secure with 4 long screws.



**STEP 10** Drop into place the Black Liner (E) to the top of the Bin.



**STEP 12** Insert Center Divider (D) into the cleats and slide it all the way into the bin.

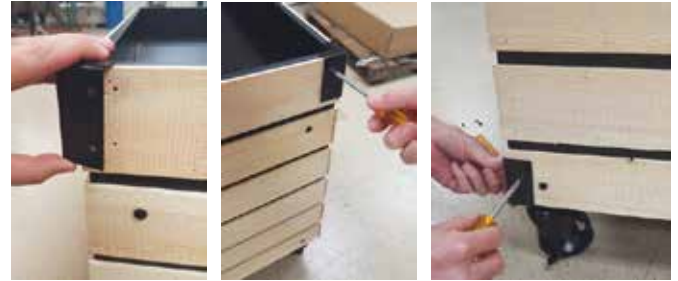

**STEP 11** Install 1 Handle to each of the 4 sides of the Bin using 5 screws (included). Line up the holes of the handle with the pilot holes provided. Do not Over Tighten. These are Decorative Handles Only.



Assembly Complete

