

Gondola Sign, Chalkboard Header, 36W & 48W (ACH03 & ACH04)

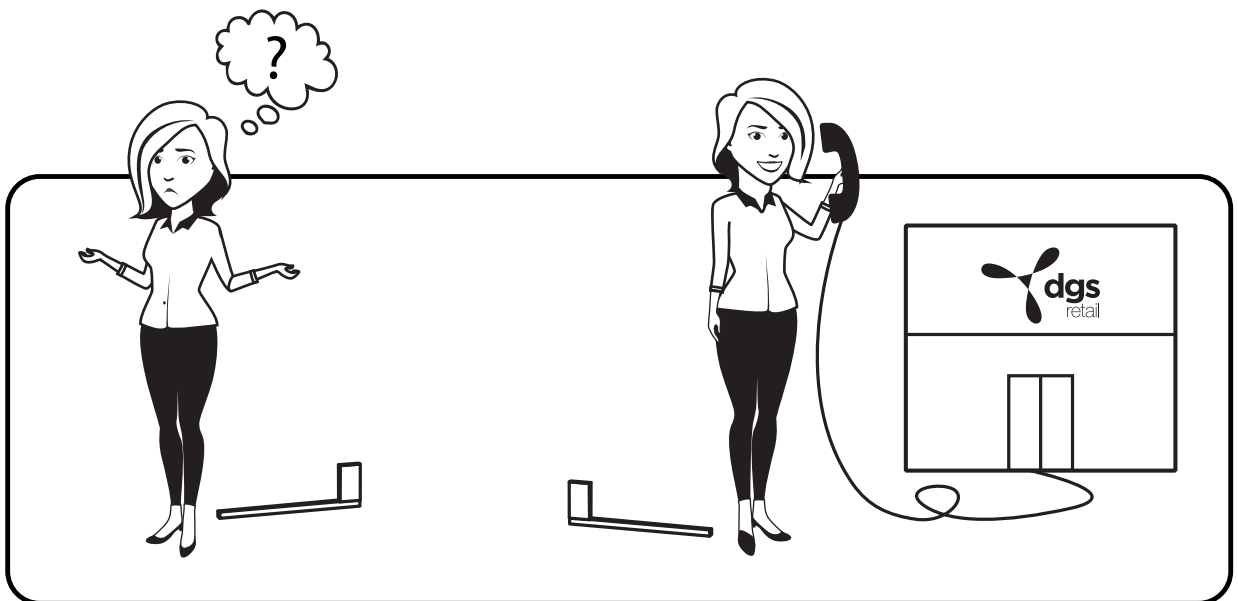

Part List:

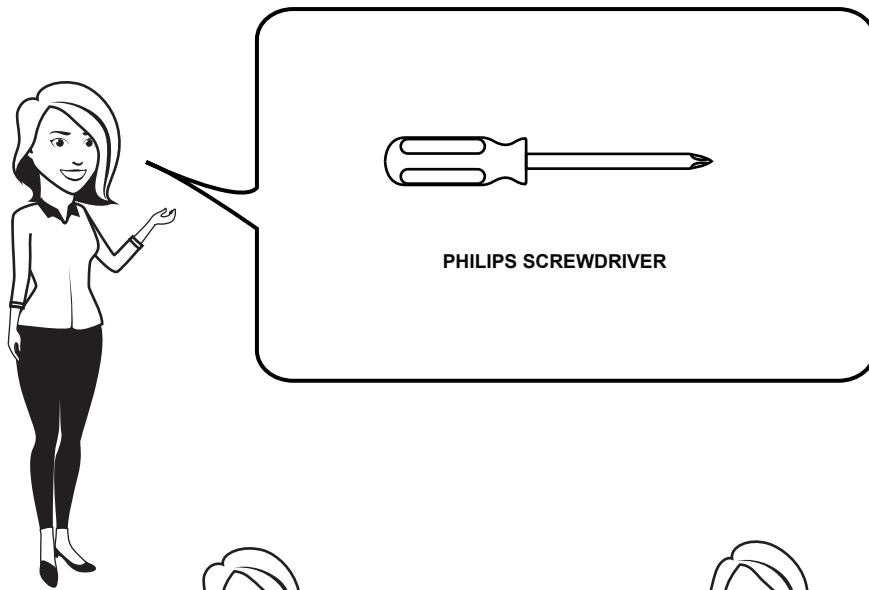
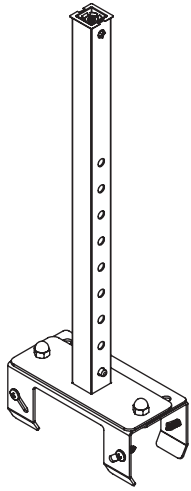

Adjustable Base With
Square Telescopic Tube x2

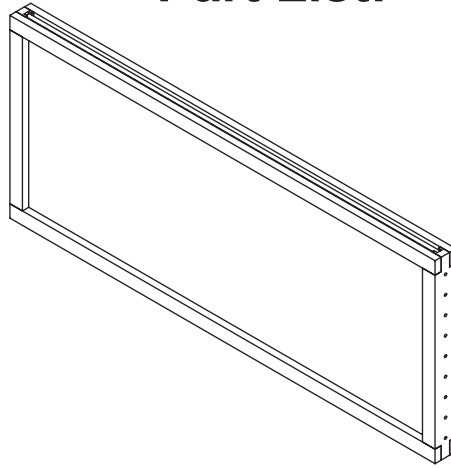

Gondola Sign Chalkboard Assembly x1



Chalkboard Sign
Hanging Bracket x2

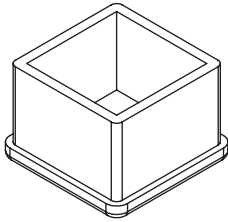

Tube Cap x2

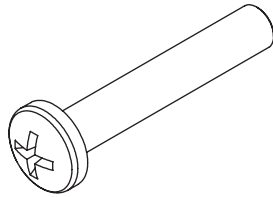

1/4-20 x 1.5L Philips
Head Machine Screw x2

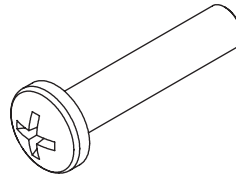

1/4-20 x 1.25L Philips
Head Machine Screw x2

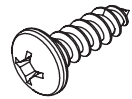

#10 x .625\"/>



#8 x .375\"/>

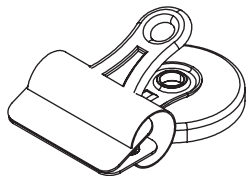

Bulldog Magnetic Clip,
29mm Base x2

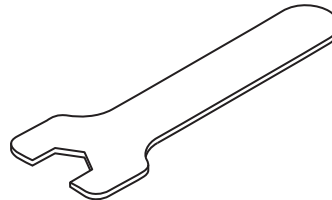

Wrench x1

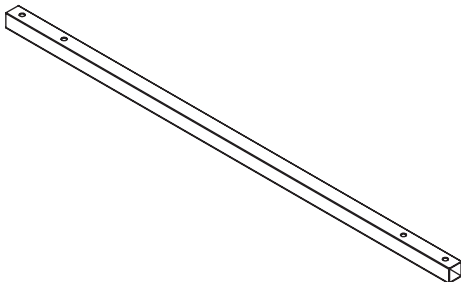

Only for 3ft wide sign:
Header Rail Top Tube 29.4\"/>

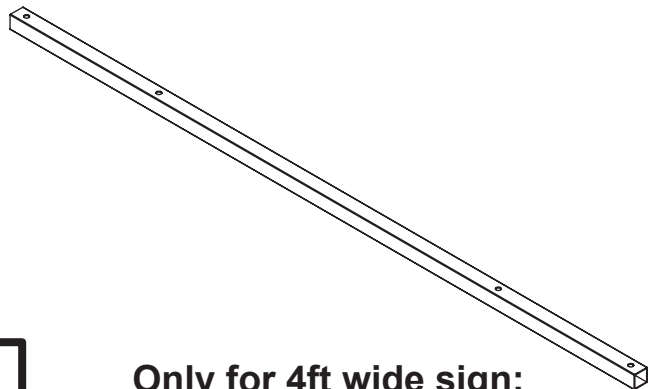

Only for 4ft wide sign:
Header Rail Top Tube 41.4\"/>

1**Assemble Adjustable Bracket:**

If the bracket comes disassembled in a kit, assemble it properly and adjust its size based on the installation method. Don't fully tighten the nuts as this will be done later.

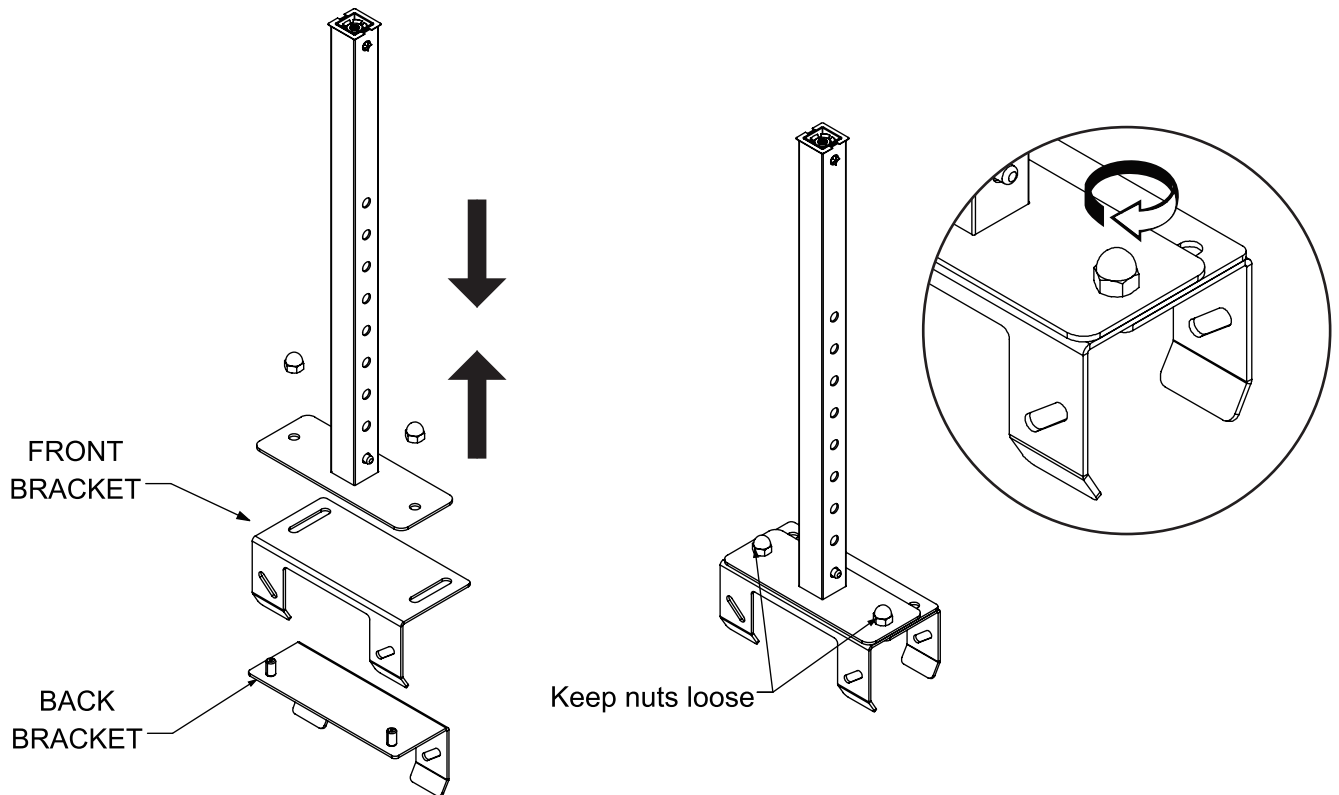
**2****Assemble Chalkboard Panel with Hanging Brackets:**

Align holes on sides of wood frame with holes on hanging brackets, and use appropriate set of two holes on each side to get required mounting height of chalkboard. Adjustments can be made in 1" increments from 0" (standard highest setting) to (-) 7" (lowest setting).

Attach securely each hanging brackets to the frame using (2x) #8 X .375" wood screw (4 screws in total).

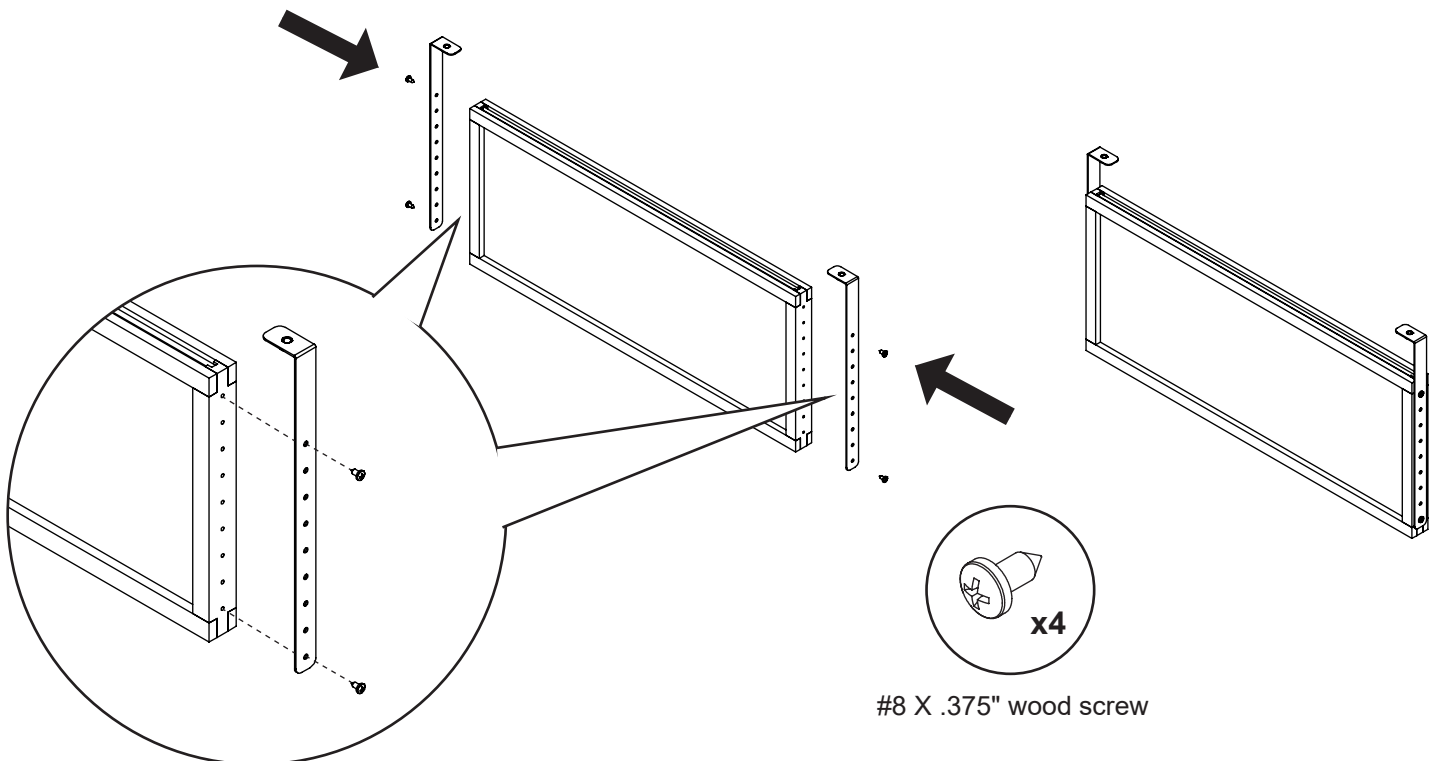

3**Assemble Rail Top Tube with Side Tube Caps:**

Press-in tube cap on each side of tub. Use hammer or rubber mallet if necessary.

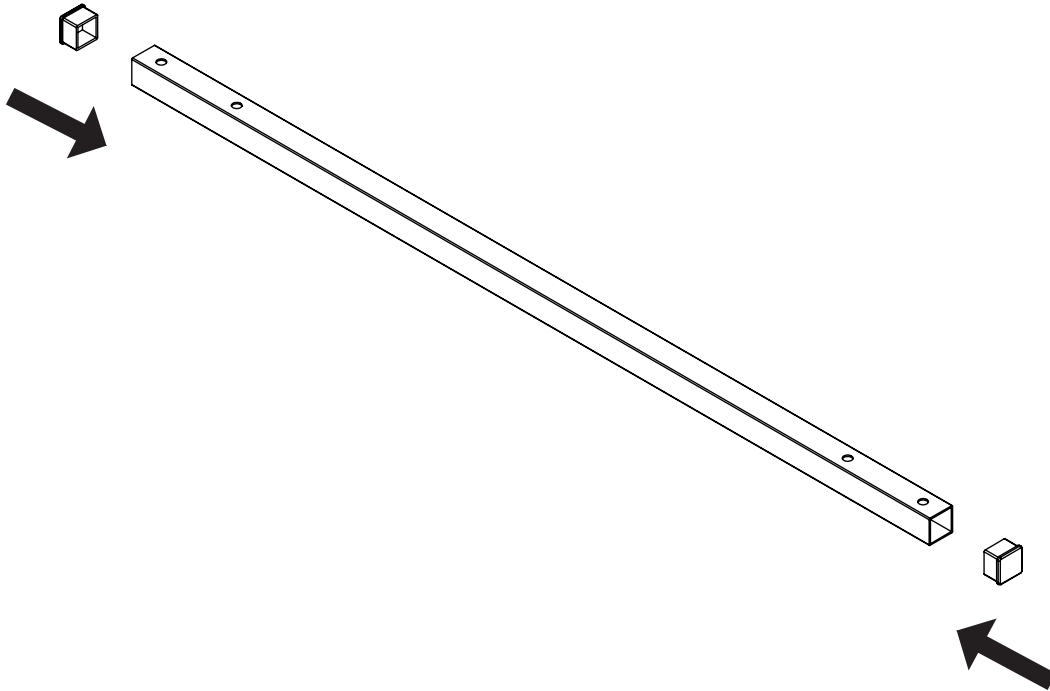
**4****Assemble Chalkboard Frame to Top Tube:**

Align 2 center holes on top tube with holes in hanging brackets, and attach securely top tube to brackets using (2x) 1/4-20 X 1.250"L machine screws.

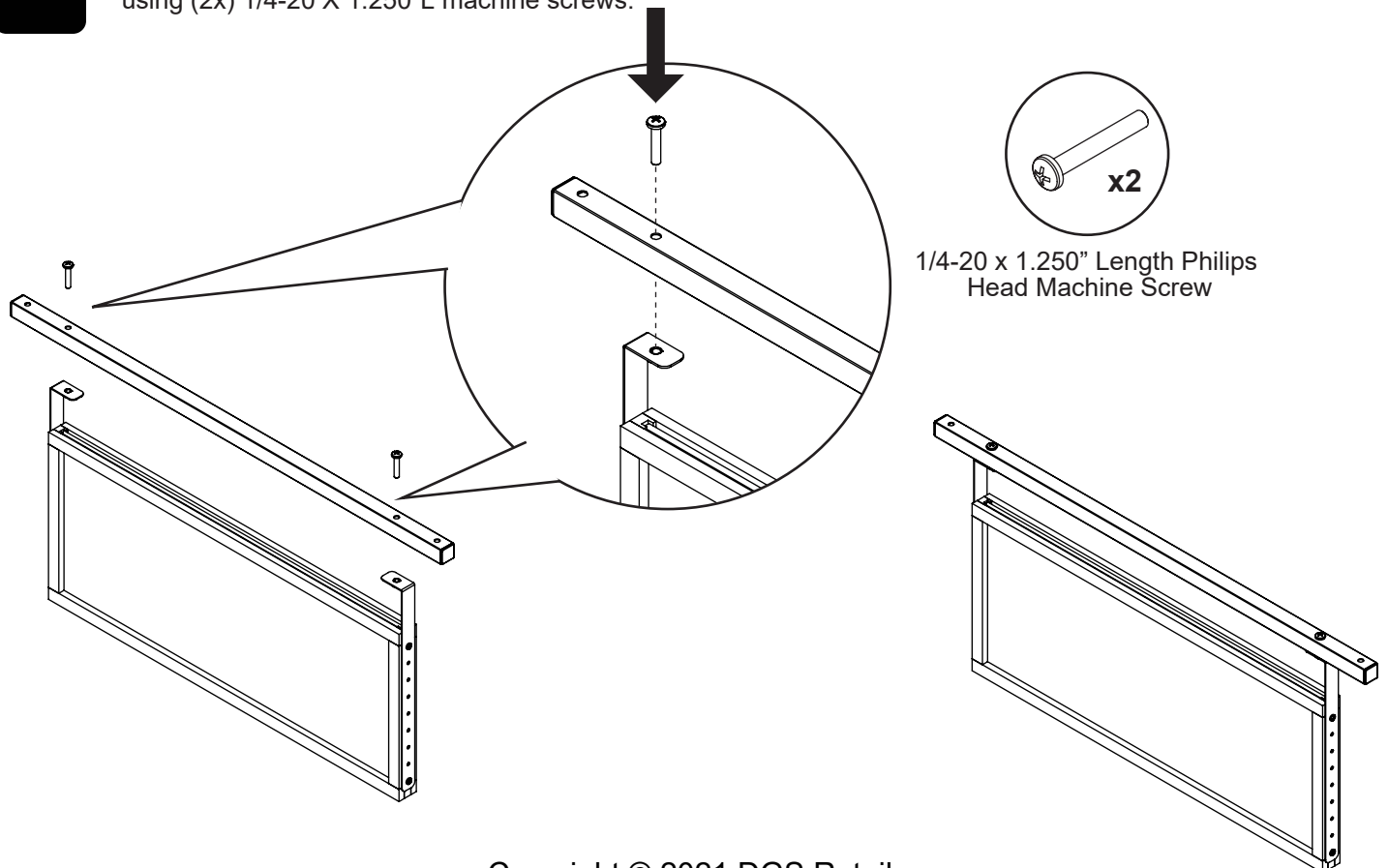

5**Assemble Adjustable Bases With Top Tube:**

Align 2 end holes on top tube with holes in tube inserts inside vertical tubes, and attach securely top tube to bases using (2x) 1/4-20 X 1.500"L machine screws.

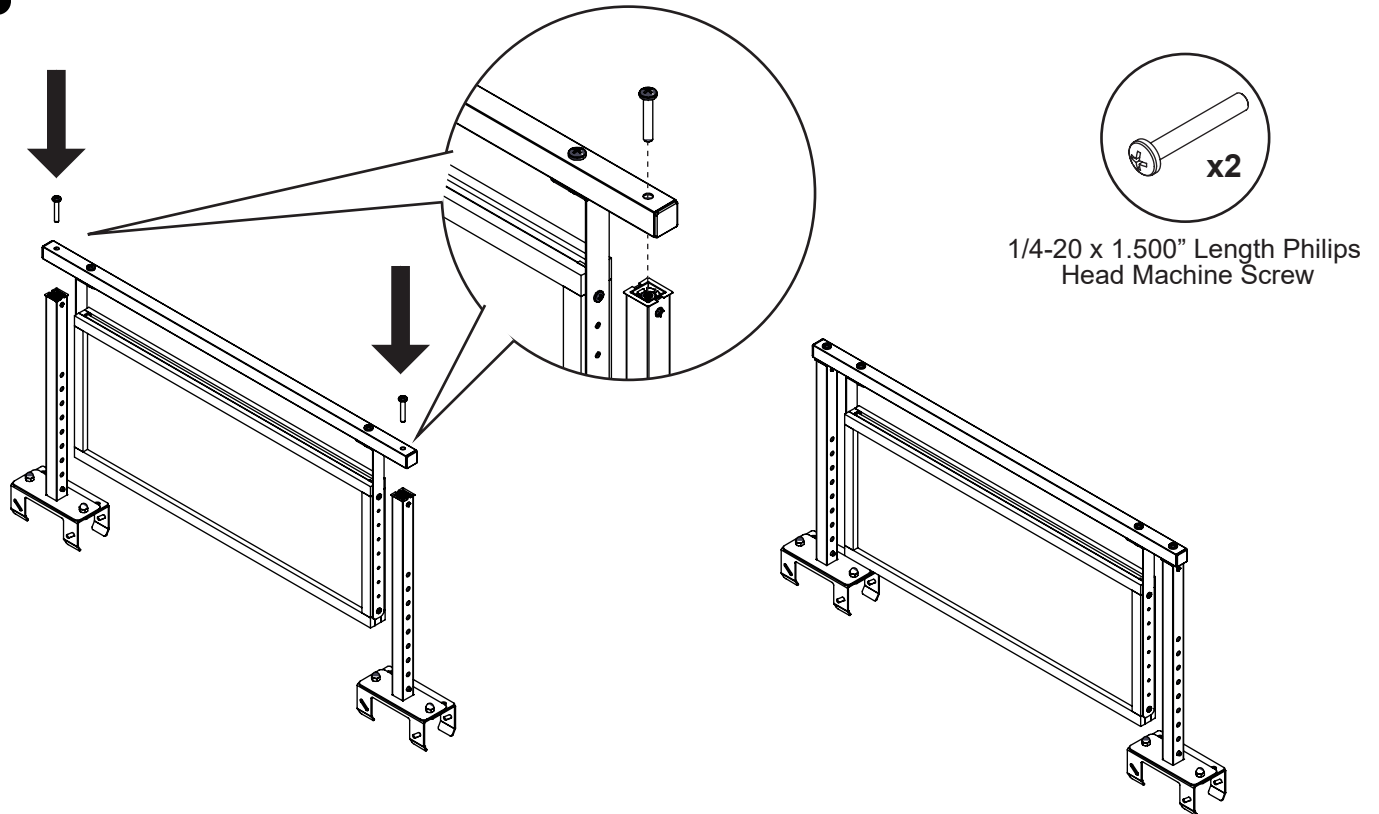
**6****Install Sign on Top of Gondola:**

Loosen acorn nuts on top of telescopic base and slide-open the base bracket. Place entire assembly on top of gondola, slide back (bottom) bracket all the way toward gondola's panel. Make sure that bottom surface of bracket lays flat on top of gondola's cross rail.

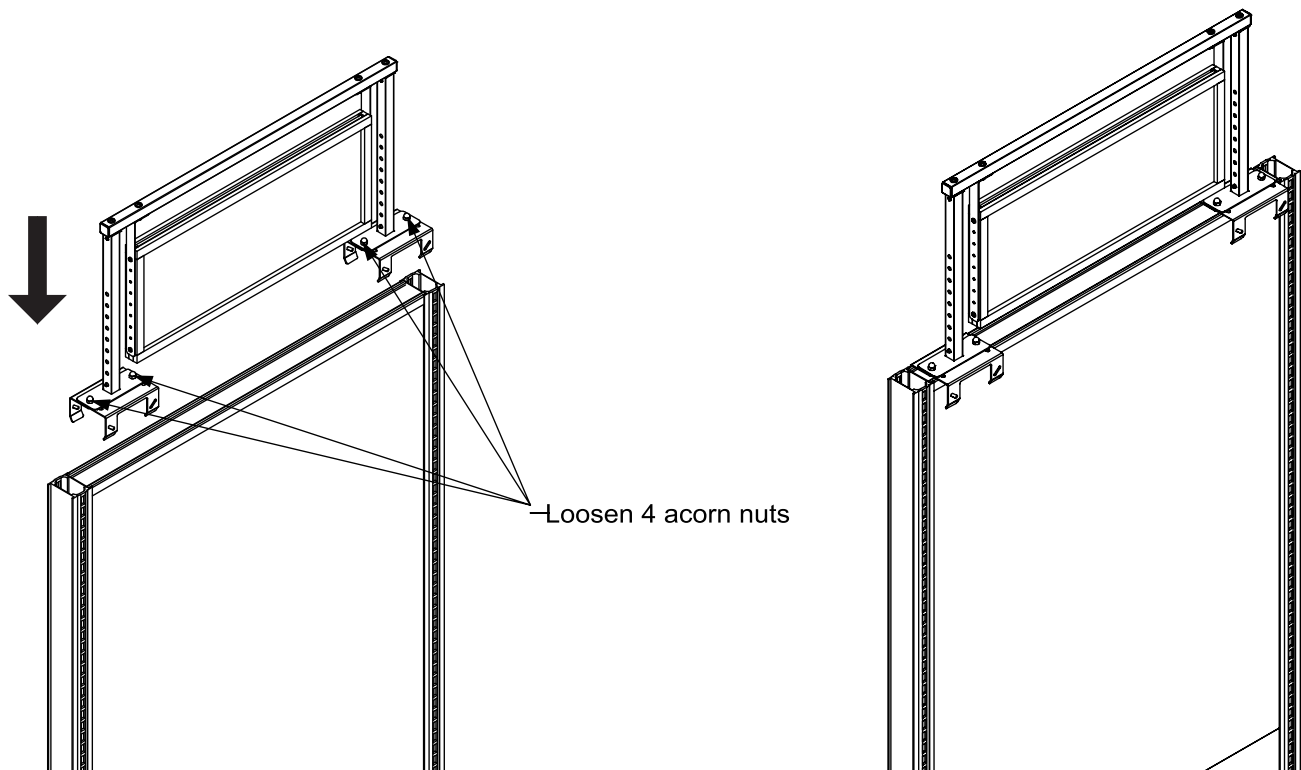

7

Secure Sign on Top of Gondola:

Slide front (top) brackets on base all the way toward wood panel on gondola, and secure them to wood panel of gondola using (8x) #10 x .625" L PH wood screws through slots in brackets. Tighten top acorn nuts .

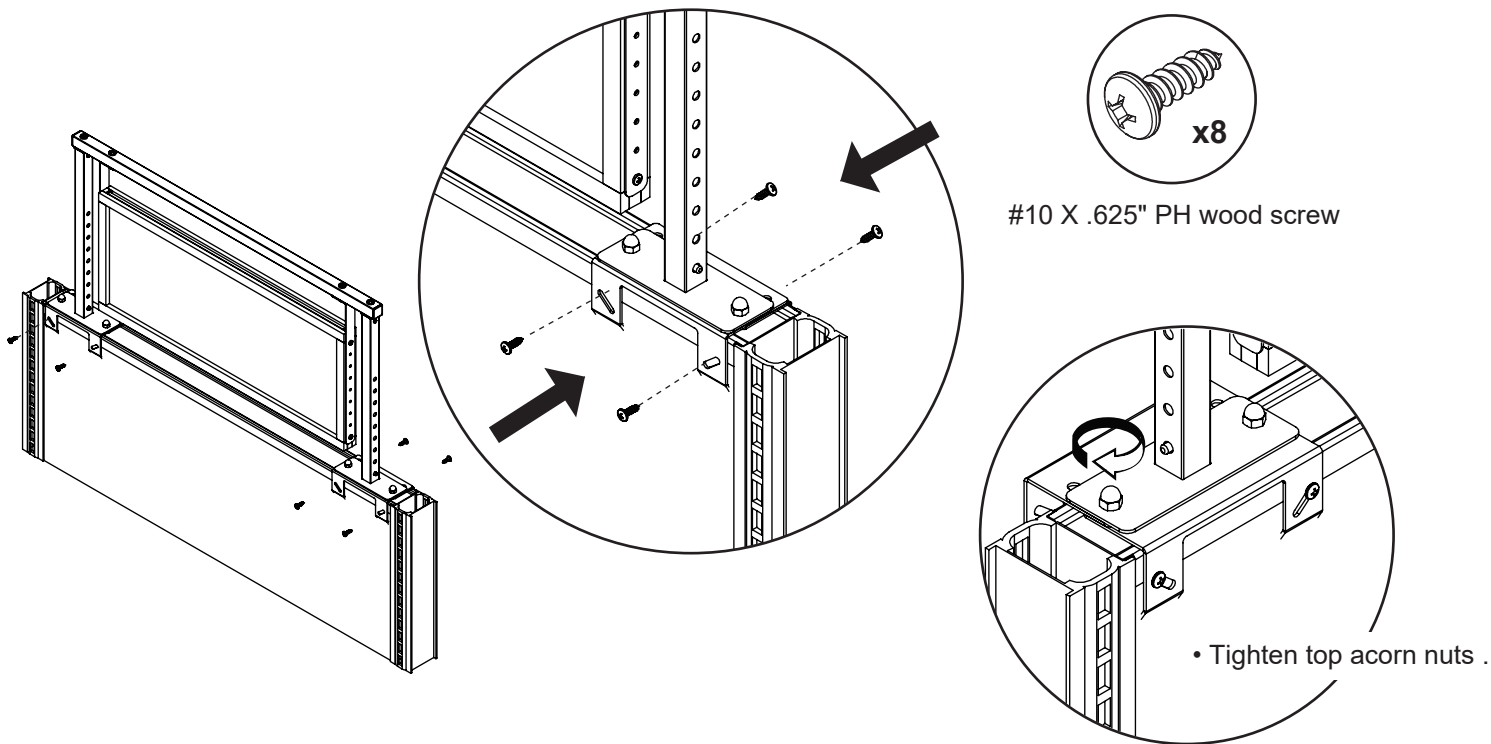

8

Place Magnet Clips on Chalkboard and Adjust Height of Sign::

If required, adjust height of sign by pressing spring buttons on telescopic tubes and sliding the sign up to the necessary position. Height can be adjusted in 1" in increments, and can be changed from 0" up to 8".

