

Gondola Sign, Chalkboard Header, 96W (ACH08)

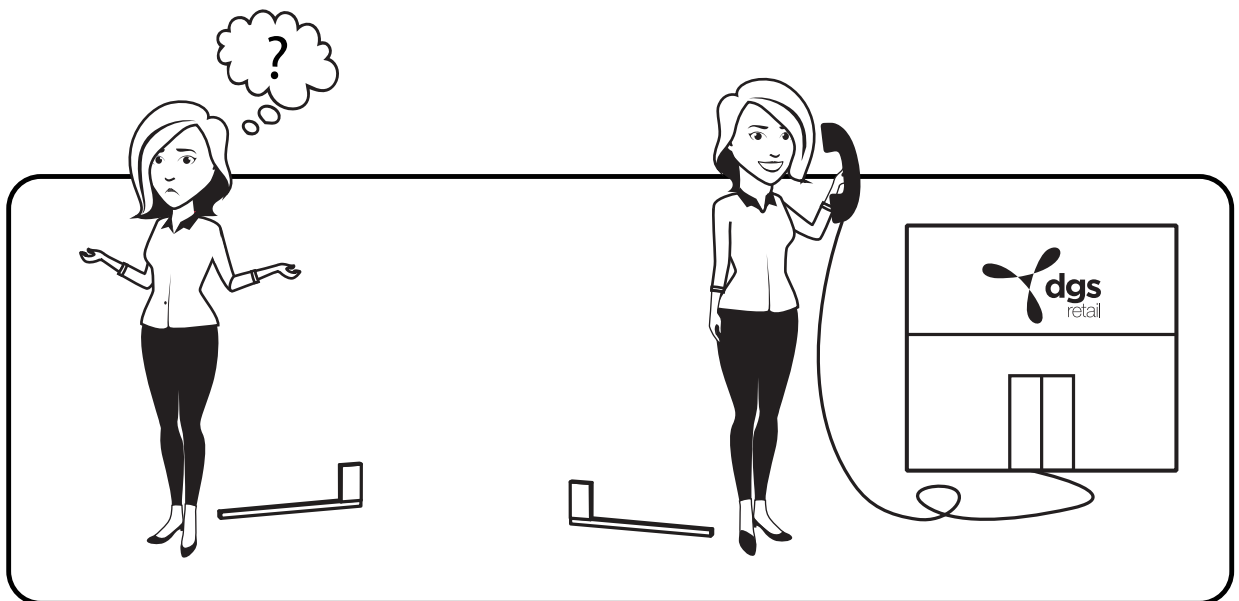

Part List:

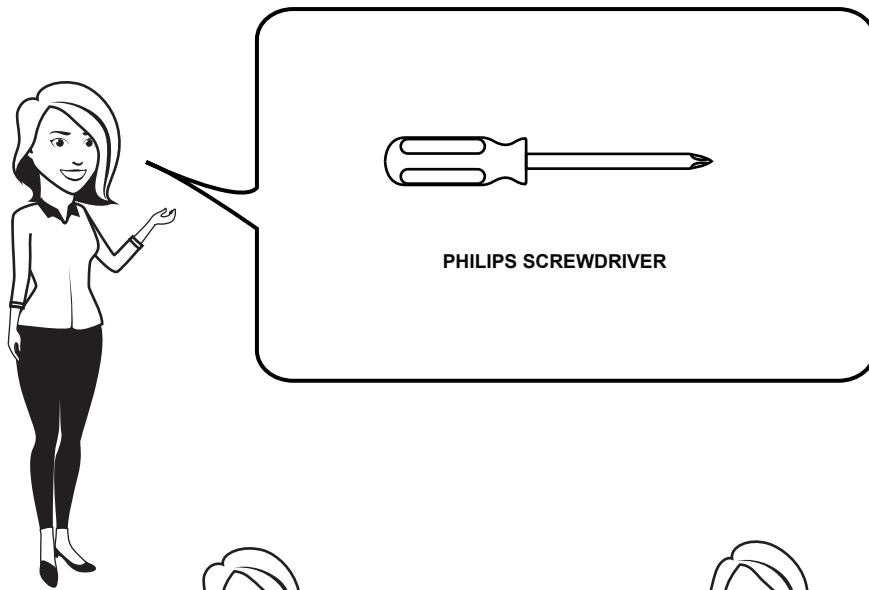
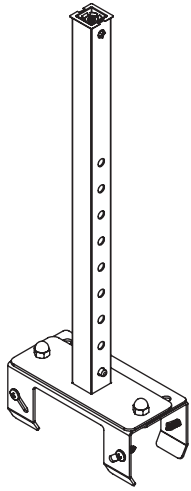

Adjustable Base With
Square Telescopic Tube x4

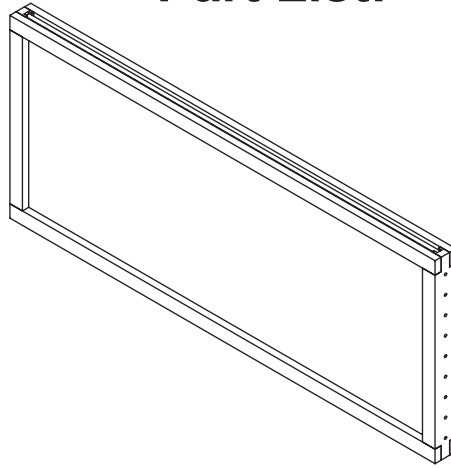

Gondola Sign Chalkboard Assembly x3



Chalkboard Sign
Hanging Bracket x6

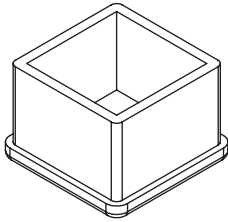

Tube Cap x2

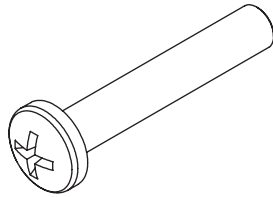

1/4-20 x 1.5L Philips
Head Machine Screw x4

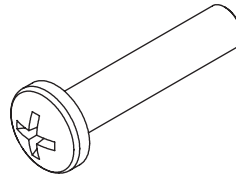

1/4-20 x 1.25L Philips
Head Machine Screw x6

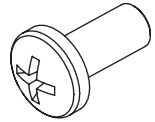

1/4-20 x .500 L Philips
Head Machine Screw x2



#8 x .375"L Philips Head
Wood Screw x12

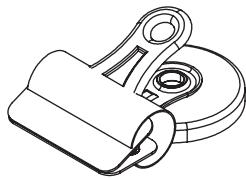

Bulldog Magnetic Clip,
29mm Base x6

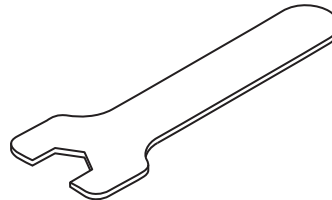

Wrench x1

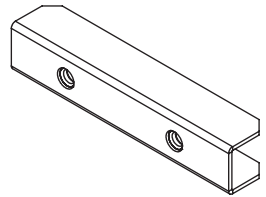

Horizontal Rail Connector x1

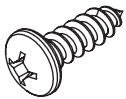

#10 x .625"L Philips
Head Wood Screw x24

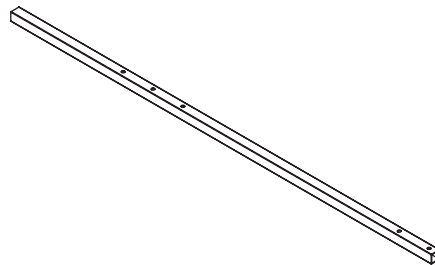

Top Tube x2

1**Assemble Adjustable Bracket (x4):**

If the bracket comes disassembled in a kit, assemble it properly and adjust its size based on the installation method. Don't fully tighten the nuts as this will be done later.

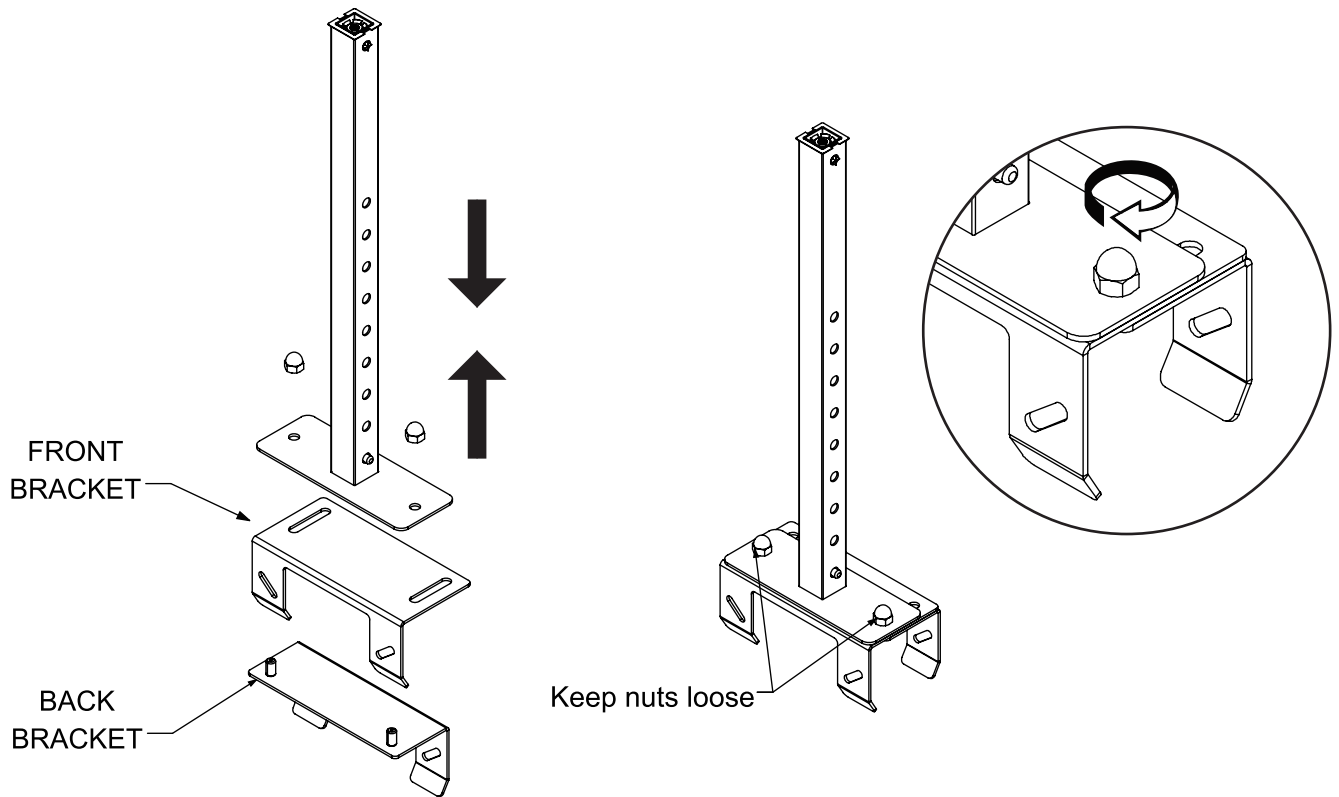
**2****Assemble Chalkboard Panel with Hanging Brackets (x3):**

Align holes on sides of wood frame with holes on hanging brackets, and use appropriate set of two holes on each side to get required mounting height of chalkboard. Adjustments can be made in 1" increments from 0" (standard highest setting) to (-) 7" (lowest setting).

Attach securely each hanging brackets to the frame using (2x) #8 X .375" wood screws (4 screws per frame)

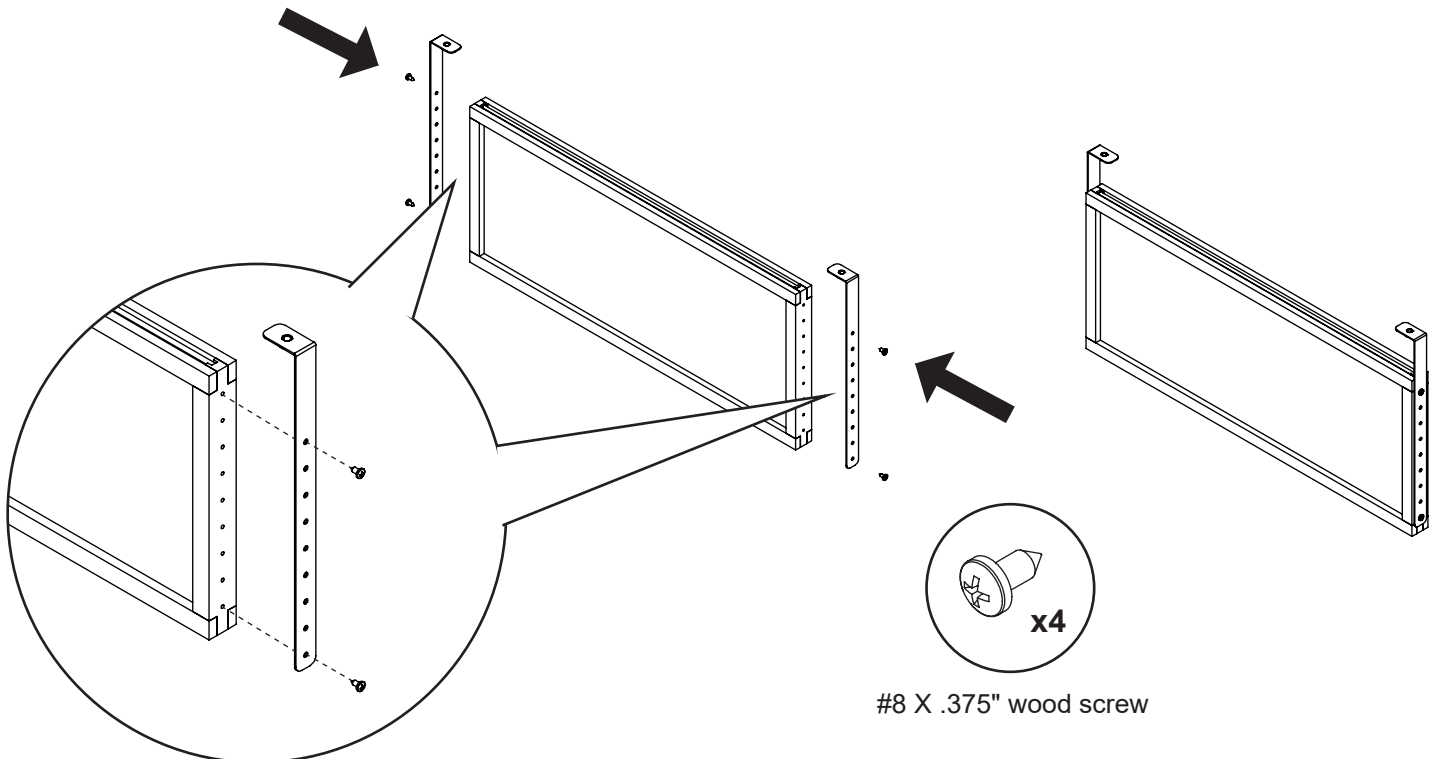

3

Assemble Top Right Tube with Tube Cap and Horizontal Rail Connector:

Press-in tube cap on side of tube where hole closest to the edge goes through both walls.

Use hammer or rubber mallet if necessary.

Slide-in horizontal rail connector to the side of tube where hole closest to the edge goes through one wall, and attach connector securely using (1x) 1/4"-20 x .500"L machine screws.

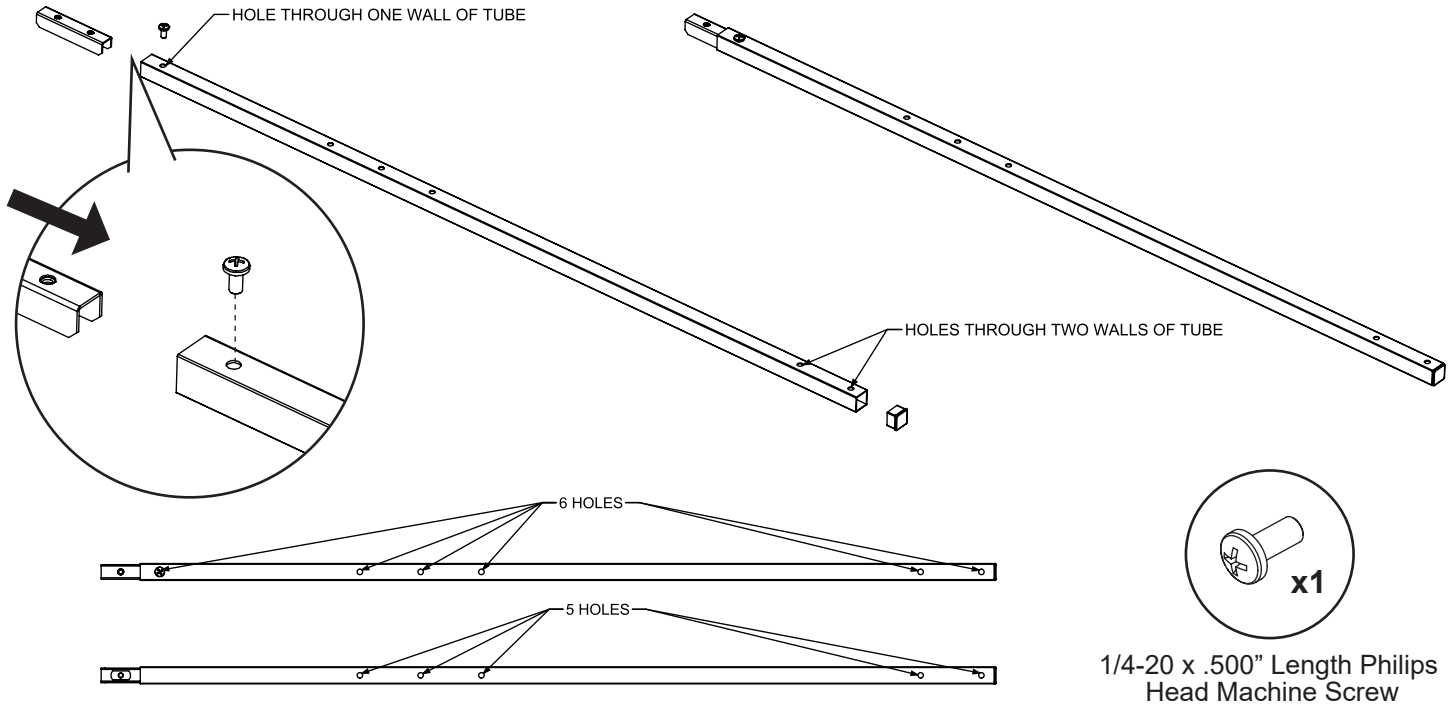

4

Assemble Top Left Tube with Tube Cap (x1):

Press-in tube cap on side of tube where hole closest to the edge goes through both walls.

Use hammer or rubber mallet if necessary.

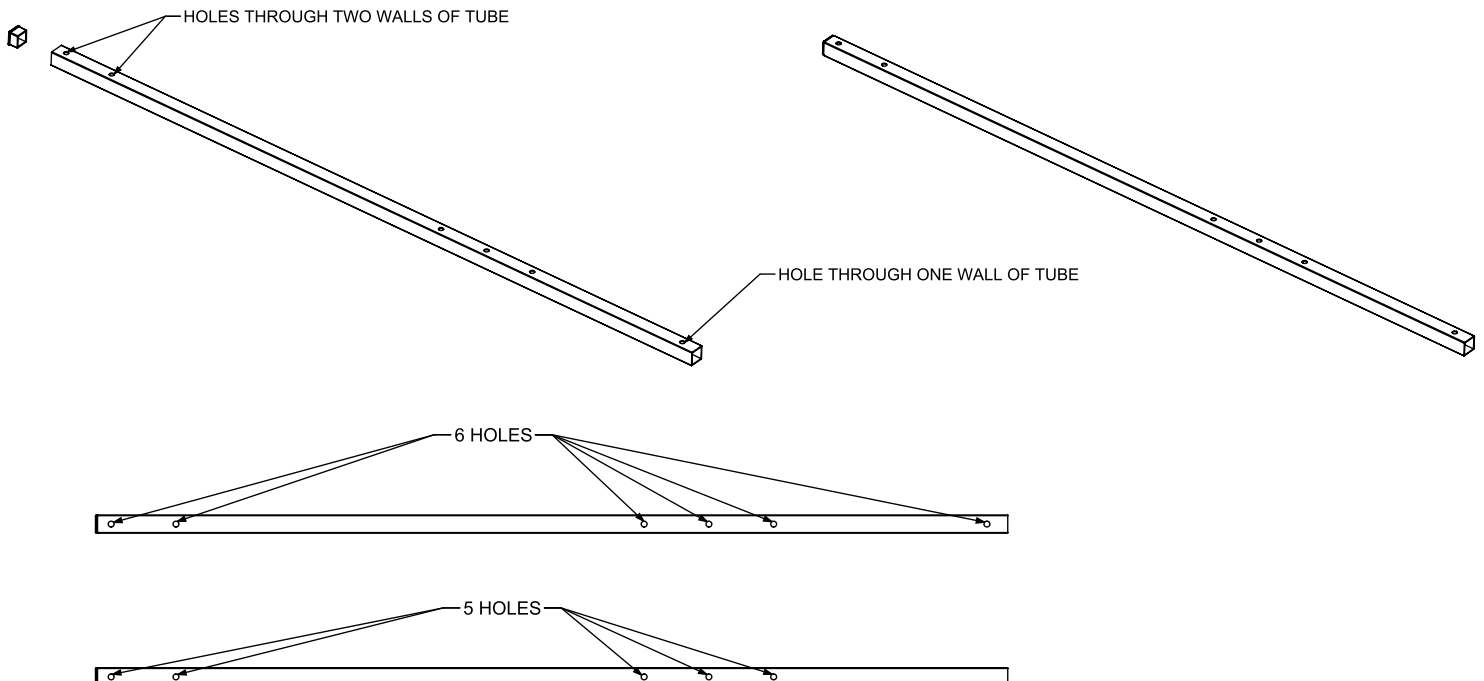

5

Assemble Chalkboard Frame with Left Tube sub-assembly:

Align 2 holes on tube with holes in hanging brackets, and attach securely tube to brackets using (2x) 1/4-20 X 1.250"L machine screws. Use second and third holes from plastic tube cap for frame attachment.

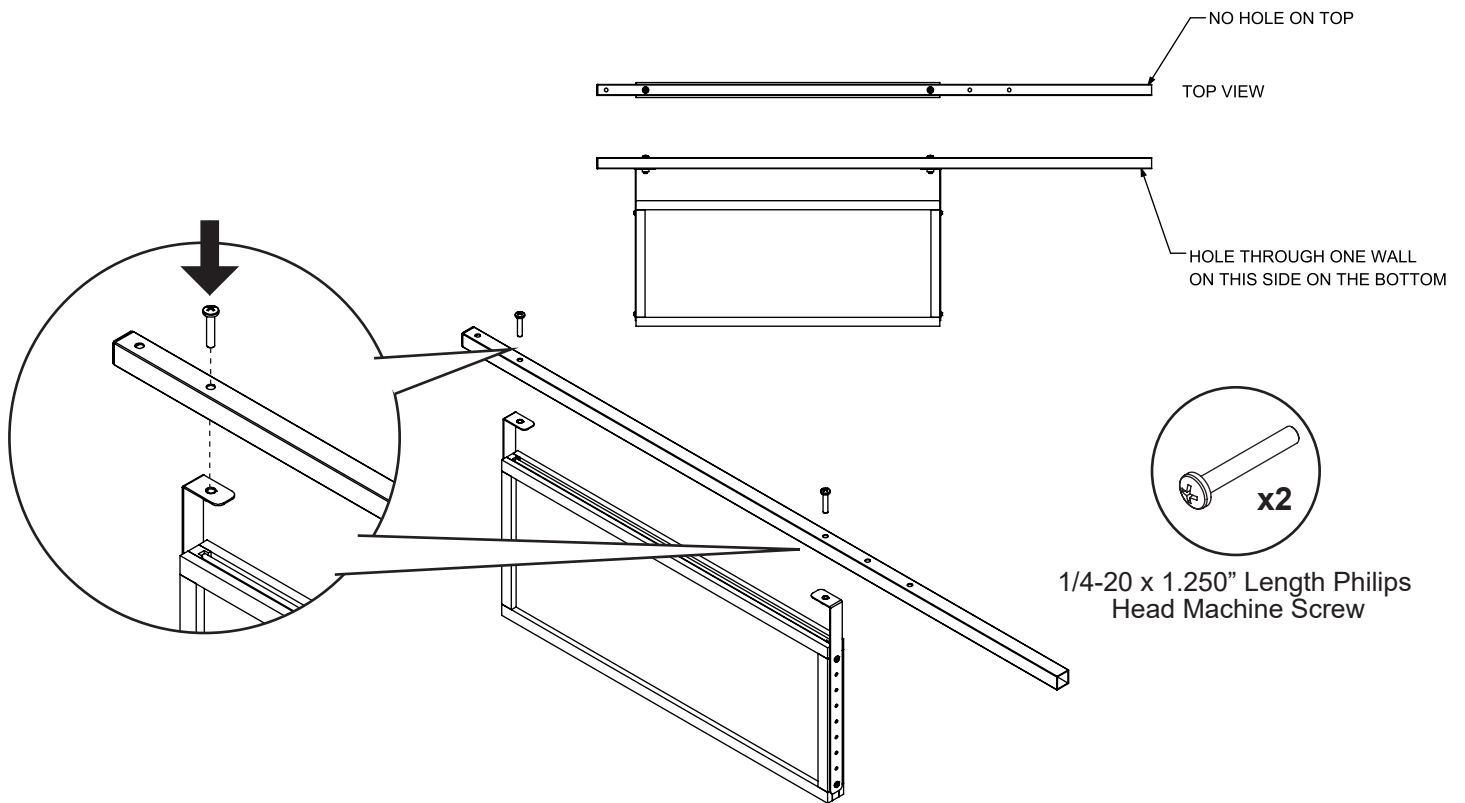

6

Assemble Chalkboard Frame with Right Tube sub-assembly:

Align 2 holes on tube with holes in hanging brackets, and attach securely tube to brackets using (2x) 1/4-20 X 1.250"L machine screws. Use second and third holes from plastic tube cap for frame attachment.

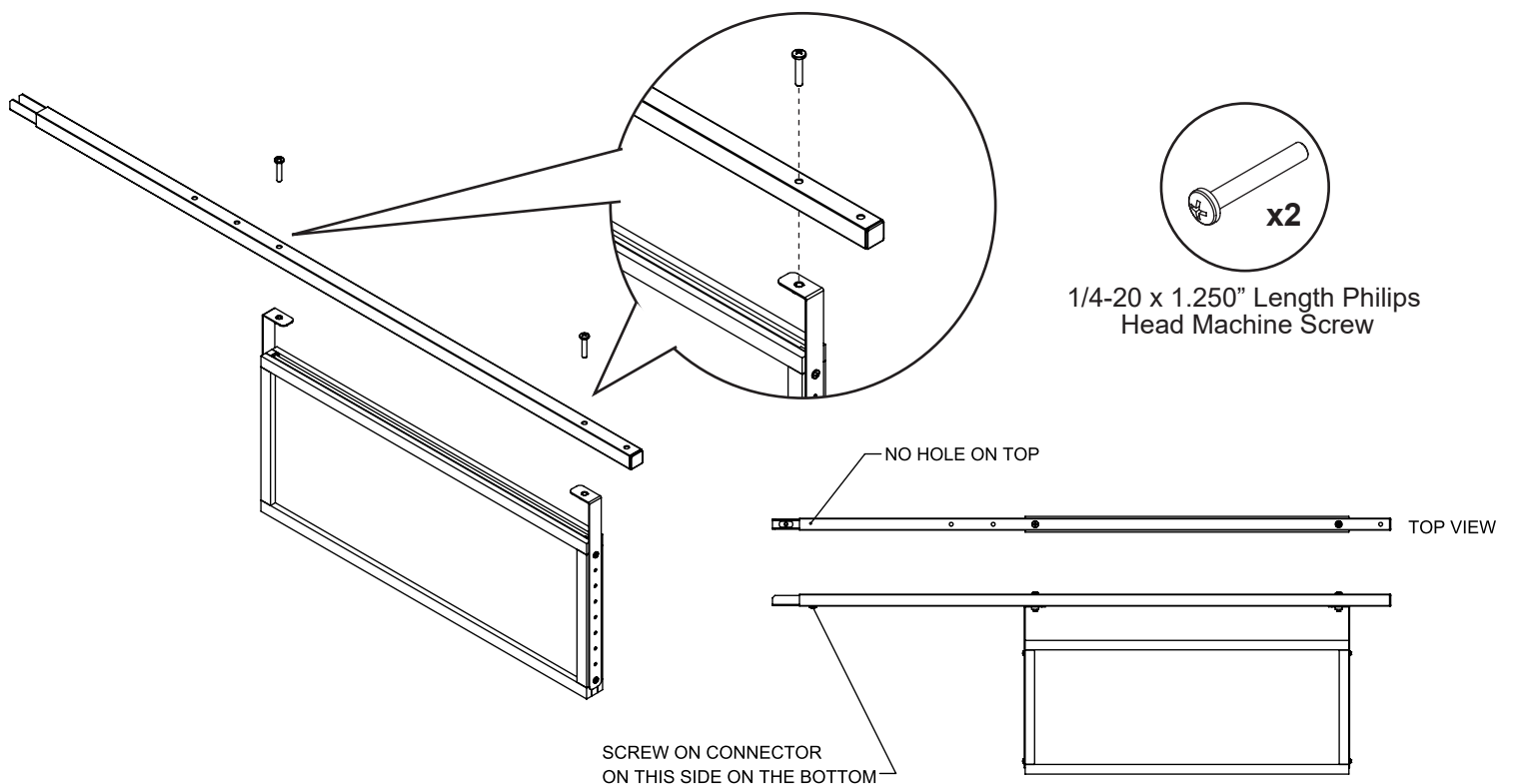

7

Assemble Side Chalkboard Frame with Top Tube Subassembly with Adjustable Bases:

Line up bases on the ground and starting at one end of the setup align 1st and 4th holes on top tube (counting from plastic cap) with holes in tube inserts inside vertical tubes, and attach securely frame assembly to bases using (2x) 1/4-20 X 1.500"L machine screw. Plastic tube end cap needs to be facing outside.

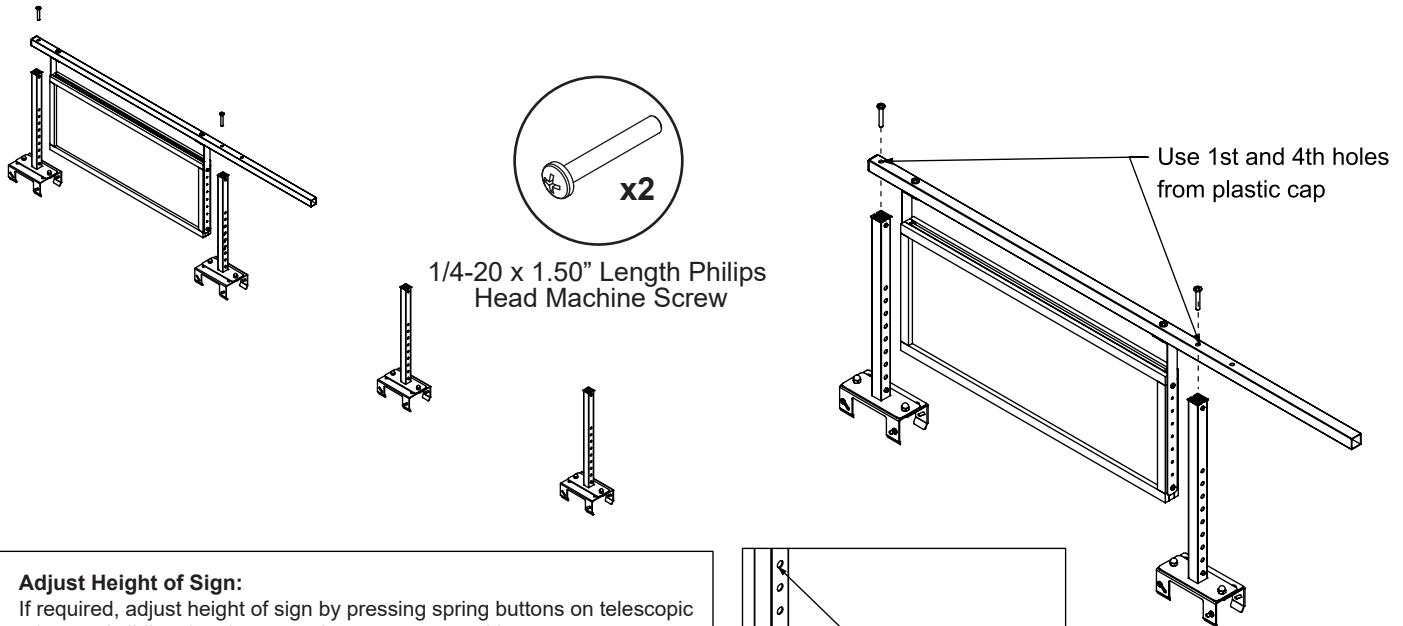

Adjust Height of Sign:

If required, adjust height of sign by pressing spring buttons on telescopic tubes and sliding the sign up to the necessary position. Height can be adjusted in 1" increments, and can be changed from 0" up to 8". All vertical posts have to be adjusted to the same height in order for the sign to be level. Height adjustment is possible after the sign is fully assembled.

8

Assemble Second Side Chalkboard Frame with Top Tube Subassembly with Adjustable Bases:

Slide horn on side top tube into open end already installed top tube, align holes and attach top tube using (1x) 1/4-20 X .500"L machine screw.

- Attach top tube to two side bases through top holes using (2x) 1/4-20 X 1.500"L machine screws.

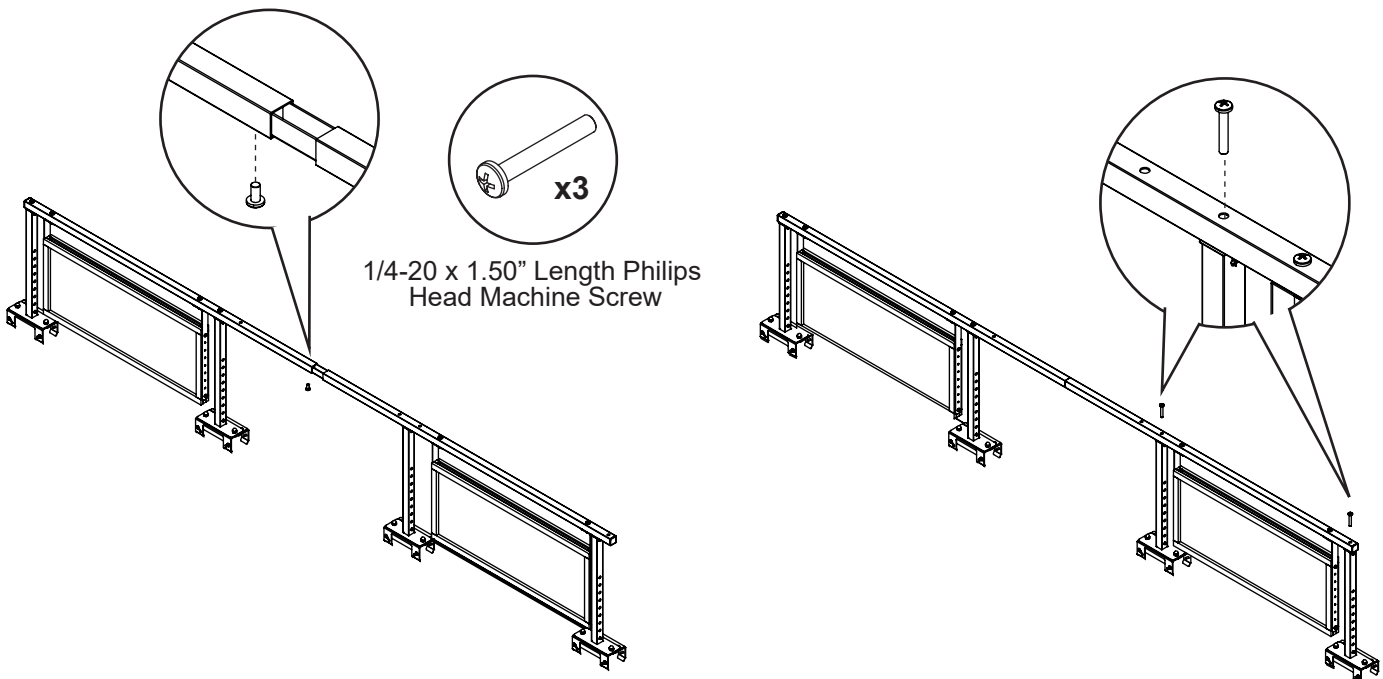

9

Assemble Center Chalkboard Frame with Top Tubes:

Align 2 center holes on top tube with holes in hanging brackets, and attach securely top tube to brackets using (2x) 1/4-20 X 1.250"L machine screws.

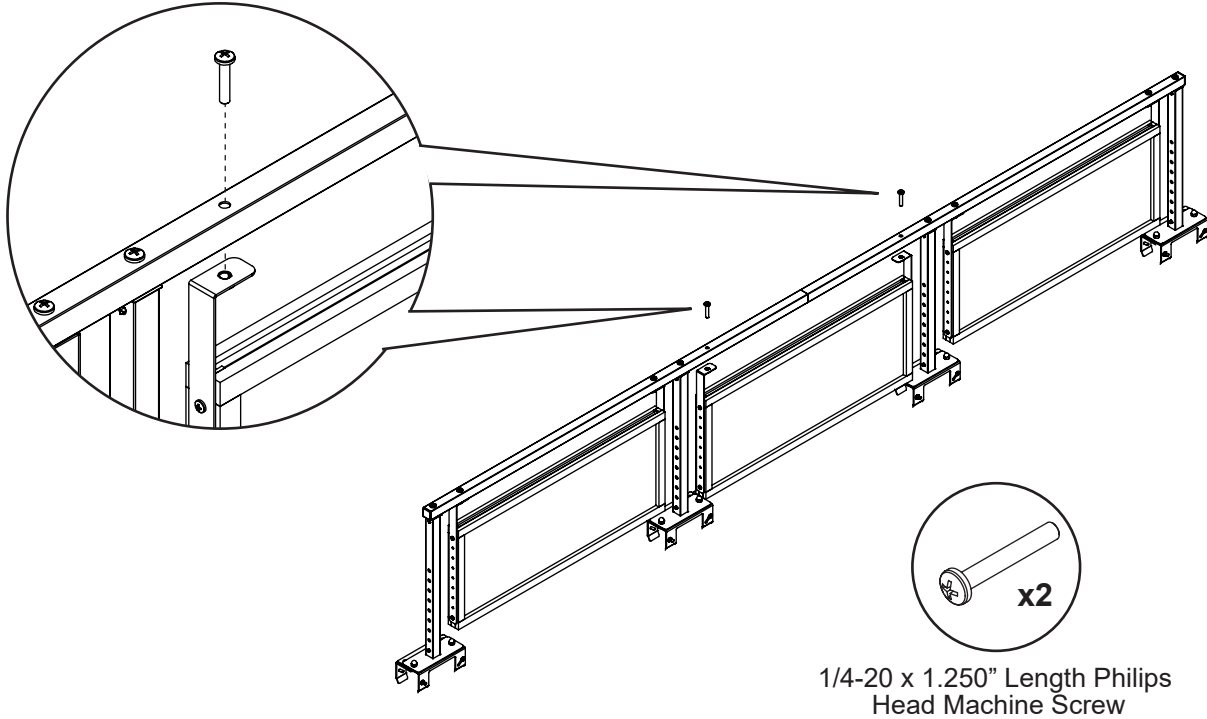

10

Place Chalkboard Frame Assembly on Top of Gondola:

Proceed to slide front and back brackets on base all the way toward wood panel on gondola, and attach it securely to wood panel of gondola using (4x) #10 x .625"L PH wood screw through slots in brackets. Tighten top acorn nuts.

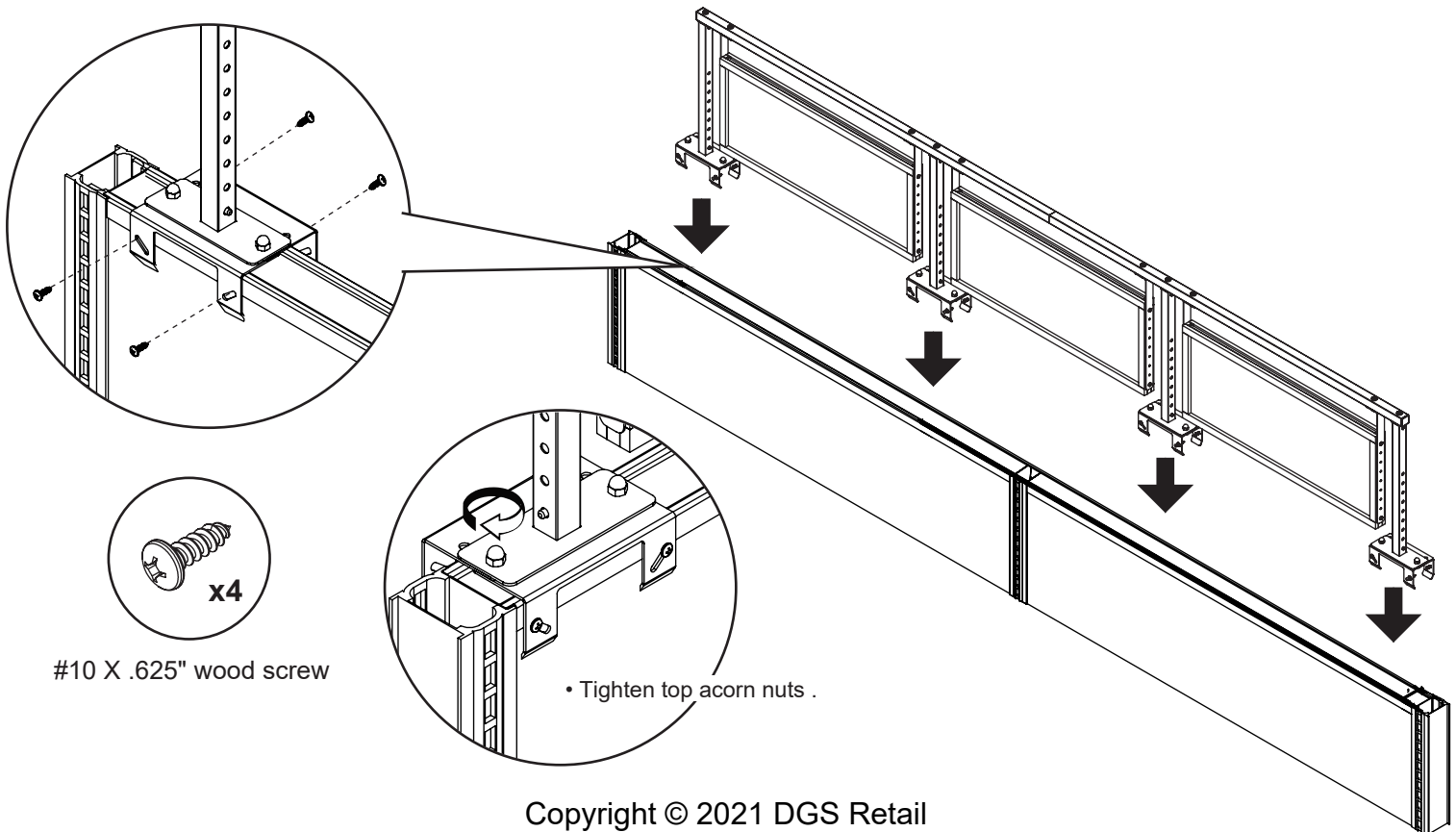

11

Place Magnet Clips on Chalkboard.
Adjust Height if not completed in step 7.

